**TBD East Superior
Street
Pasco, WA**

Shop/Office for Lease

KIRT SHAFFER
509.521.9183
kirt@tippettcompany.com



TBD East Superior Street

Owner:	K & S Family Enterprises, LLC
Tax Parcel No.:	113-474-027
Lot Size:	2.36 Acres / 102,801 s.f.
Building:	+/- 18,000 s.f. 10,240 Laydown Yard
Lease Premises:	5,040 s.f.
Zoning:	C-3 General Business District
Grade Level Doors:	4 (14' x 14')
Utilities:	Separately Metered (Tenant pays directly)
Lease Price:	\$0.65/s.f. – Warehouse \$1.25/s.f. - Office
Lease Type:	NNN (\$0.12/mo.)

Building is currently under construction with a scheduled completion date of February 2020. Building will have 3-Phase Power, 20' eave height, R30 insulation in walls, R39 insulation in ceiling, as well as heat and a/c. Up to 10,240 s.f. of laydown yard available with this lease offering (\$500.00/mo.).

CONTACT:

Tippett Company
2815 St. Andrews Loop, Suite F
Off: 509.545.3355
Fax: 509.545.1689
www.tippettcompany.com

Kirt Shaffer / Managing Broker
509.521.9183
kirt@tippettcompany.com

No warranty or representation, expressed or implied, is made as to the accuracy of information contained herein, and same is submitted subject to errors, omission, change of price, rental or other conditions and withdrawal without notice. Lessor and his/her agent are responsible for independently verifying all presented information.

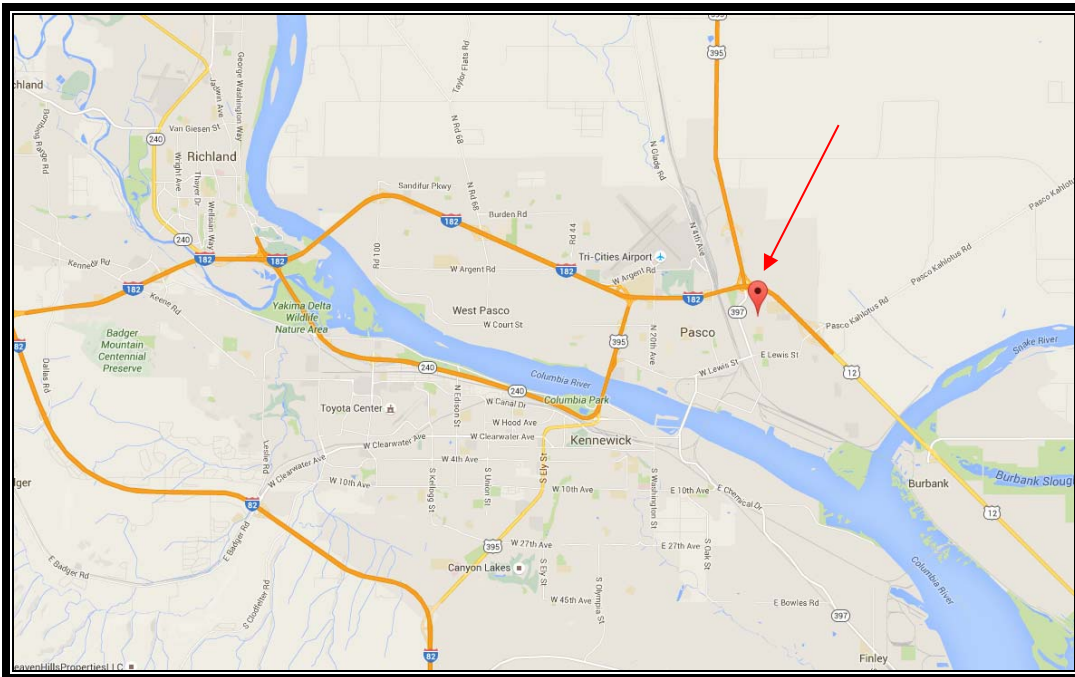

No warranty or representation, expressed or implied, is made as to the accuracy of information contained herein, and same is submitted subject to errors, omission, change of price, rental or other conditions and withdrawal without notice. Lessor and his/her agent are responsible for independently verifying all presented information.

OVERALL FLOOR PLAN

North 

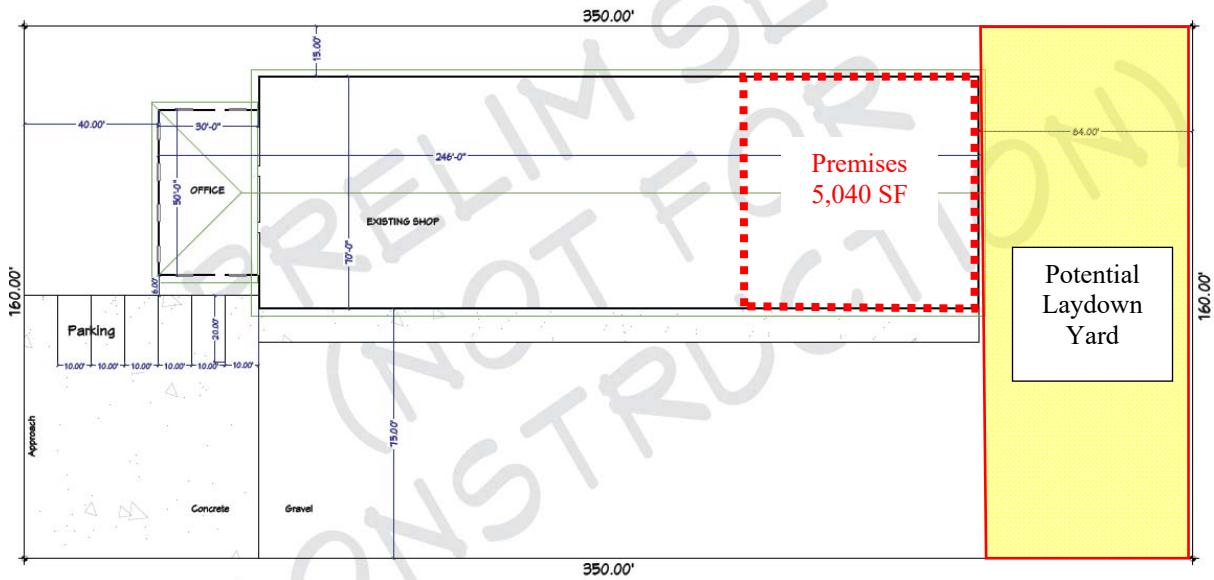

No warranty or representation, expressed or implied, is made as to the accuracy of information contained herein, and same is submitted subject to errors, omission, change of price, rental or other conditions and withdrawal without notice. Lessor and his/her agent are responsible for independently verifying all presented information.